

**VS 470 MK II
PLATFORM SUPPLY VESSEL (DP1)**



E.R. KRISTIANSAND, E.R. BERGEN

E.R. ARENDAL

E.R. Offshore GmbH & Cie. KG
Hohe Bleichen 12
20354 Hamburg

Telephone +49-40-3008-0
Telefax +49-40-3008-1000
www.er-ship.com

VESSEL SPECIFICATION

GENERAL	E.R. KRISTIANSAND	E.R. BERGEN	E.R. ARENDAL
Managers	E.R. Offshore GmbH & Cie. KG		
Builder	Kleven		
Yard Numer	307	308	309
Buit	Dec 05	Apr 06	Jul 06
Flag	Antigua & Barbuda	Antigua & Barbuda	Antigua & Barbuda
IMO Number	9350240	9359208	9365104
Call Sign	V2BP7	V2BR1	Antigua & Barbuda
Classification	+1A1, SF, EO, DYNAPOS AUT, DK(+), HL (2.5)		
LOA	73,40 m		
Length bpp	64,00 m		
Breath moulded	16,60 m		
Depth to 1st deck	7,60 m		
Draught max.	6,50 m		
GRT / NRT	2579 mt / 774 mt		
DWAT	3544 mt		
Light weight	1948,6 mt		
Speed max.	15,15 kn		
CARGO CAPACITY		DISCHARGE RATE	
Deck area	700 m ² (51 m x 13,8m)		
Deck cargo	1550 mt (5 mt/m ²)		Drill Water 2 x 100 m ³ (629 bbl) / hr
Fuel	1099 m ³ (6913 bbl)		2 x 100 m ³ (629 bbl) / hr
Liquid Mud	1072 m ³ (6743 bbl)		2 x 100 m ³ (629 bbl) / hr
Brine	1072 m ³ (6743 bbl)		2 x 70 m ³ (440 bbl) / hr
Base Oil	214 m ³ (1346 bbl)		1 x 90 m ³ (566 bbl) / hr
Dry Bulk	340 m ³ (2140 bbl)		75 mt/ hr
Potable Water	979 m ³ (6160 bbl)		2 x 29 m ³ (182 bbl) / min at 6 bar; Atlas GA 160
MACHINERY & PROPULSION			
Main Engine Set	Wärtsilä 6R32LND Total kW/BHP 2 x 2250 kW / 2 x 3020		
Shaft Generator	2 x 1300 kW (1743 BHP)		
Diesel Generator	2 x 320 kW (430 BHP) at 1800 rpm		
Emerg. Generator	1 x 75 kW (101 BHP) at 1800 rpm		
Shore Connection	300 A		
Stern Thruster	2 electr driven tunnel thrus. 588 kW (790 BHP)		
Bow Thruster	2 electr driven tunnel thrus. 588 kW (790 BHP)		
Propellers	2 x CCP dia 3000 mm		
Rudders	2 x Bekker		
NAVIGATION & COMMUNICATION			
DP	Kongsberg DP1	SDP-11	
Radar	Furuno 10 cm ARPA	FAR-2137S	
Radar	Furuno 3 cm ARPA	FAR-2117S	
GPS	Furuno	GP-90	
Gyro Compass	Simrad	GC80	
Autopilot	Simrad	AP50	
DECK			
Tugger Winch	2 x 10 t		
Windlass	2 x 12 mt (0 – 14 m/min)		
Capstans	2 x 8 t		
ACCOMMODATION			
Certificate for 23 persons.			



DRAWINGS

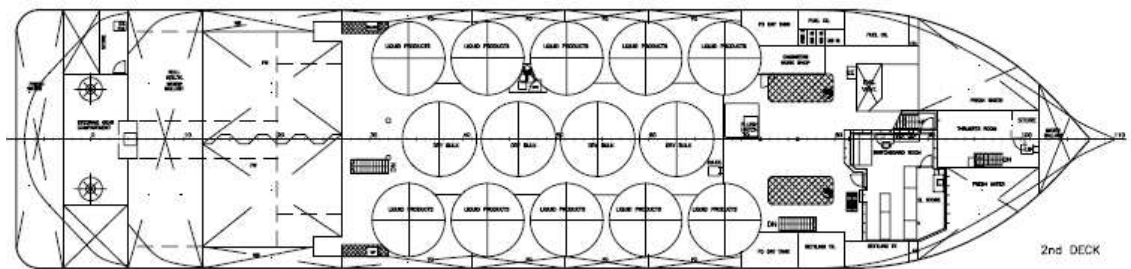
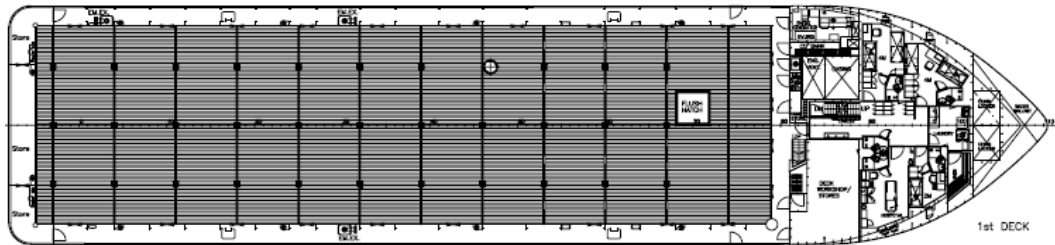
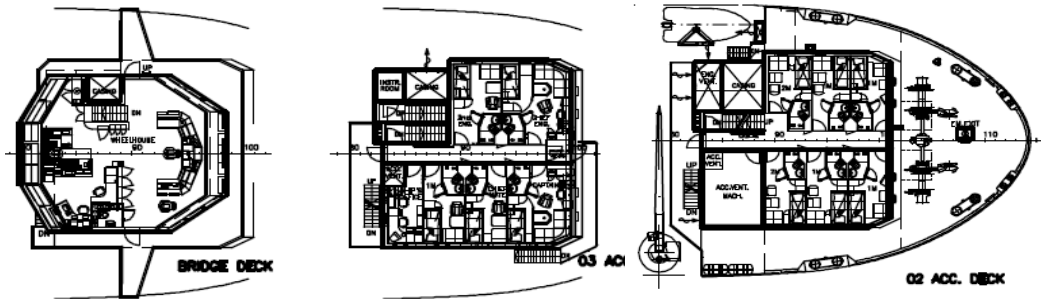
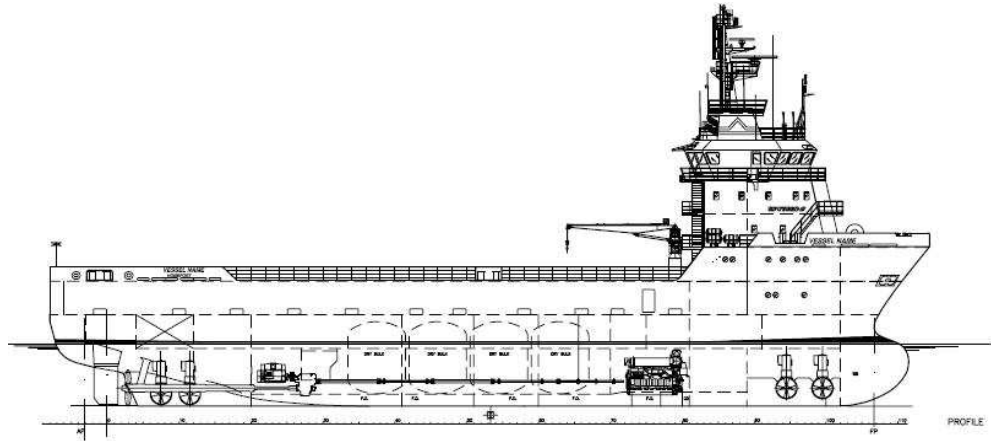

TANK CAPACITIES

TANK NO.	TANK ID	CONTENTS	VOLUME		WEIGHT (TONNES) / DENSITY (T/M ³)						
			M ³	Fresh Water	Fuel Oil	Brine	Drill Water	Mud	Dry Bulk	Base Oil	Water Ballast
1	Dry 321	Cement	85,0						204,0		
2	Dry 322	Cement	85,0						204,0		
3	Dry 323	Cement	85,0						204,0		
4	Dry 324	Cement	85,0						204,0		
5	FO 301	FO	94,6		85,14						
6	FO 302	FO	94,6		85,14						
7	FO 303	FO	92,2		82,98						
8	FO 401	FO	79,6		71,64						
9	FO 402	FO	79,6		71,64						
10	FO 501	FO	77,5		69,75						
11	FO 502	FO	89,0		80,10						
12	FO 503	FO	76,4		68,76						
13	FO 601	FO	102,2		91,98						
14	FO 602	FO	102,2		91,98						
15	FO 212	FO	43,5		39,15						
16	FO 213	FO	47,1		42,39						
17	FO 231	FO	1,1		0,99						
18	FO 207	FO	21,8		19,62						
19	FO 209	FO	43,5		39,15						
20	FO 210	FO	56,5		50,85						
21	FW 11	FW	208,2	208,2							
22	FW 12	FW	186,0	186,0							
23	FW 711	FW	244,1	244,1							
24	FW 712	FW	244,1	244,1							
25	FW 913	FW	101,0	101,0							
26	LIQ 311	MUD/BRI	107,3			268,25		268,25			
27	LIQ 312	MUD/BRI	107,3			268,25		268,25			
28	LIQ 313	MUD/BRI	107,4			268,50		268,50			
29	LIQ 314	MUD/BRI	107,4			268,50		268,50			
30	LIQ 411	MUD/BRI	107,4			268,50		268,50			
31	LIQ 412	MUD/BRI	107,4			268,50		268,50			
32	LIQ 511	MUD/BRI	107,4			268,50		268,50			
33	LIQ 512	MUD/BRI	107,4			268,50		268,50			
34	LIQ 611	MUD/BRI/BO	107,3			268,25		268,25		89,06	
35	LIQ 612	MUD/BRI/BO	107,3			268,25		268,25		89,06	
36	WB 01	WB/DW	128,4				128,40				131,61
37	WB 701	WB/DW	94,4				94,40				96,76
38	WB 702	WB/DW	91,2				91,20				93,48
39	WB 703	WB/DW	34,6				34,60				35,47
40	WB 713	WB/DW	225,0				225,00				230,63
41	WB 811	WB/DW	31,4				31,40				32,19
42	WB 812	WB/DW	31,4				31,40				32,19
43	WB 813	WB/DW	84,1				84,1				86,20
	Total Weight			983,40	991,26	2684	720,50	2684	816	178,12	738,51
	Total Volume			983,40	1101,4	1073,6	720,50	1073,6	340	214,6	1073,6

All figures and data believed to be correct, but not guaranteed

